

RAINGEAR

1947-1954 Chevrolet Truck

GETTING STARTED: SOME RECOMMENDATIONS PLEASE TRY OUR WAY FIRST!

We recommend that you familiarize yourself with the drawings and instructions before proceeding.

These instructions cover two body styles: 1947- 53 split window and 1954 curved glass truck

**This system is designed with built in adjustments to fit in your car.
If, as you are installing it, you think that you need to modify the parts
supplied (except as noted), you are doing something wrong.**

Please reread the instructions or call us (1-800-686-1955) before proceeding.
**For technical questions, etc., please contact us directly! Your dealer does not stock spare
parts and is unlikely to be able to troubleshoot problems.**

NOTE: This wiper system will not clear original upper dashboard mounted radios.

- The RAINGEAR Windshield Wiper System requires a 12-volt power source.
- The kit does not include the outside chrome escutcheons, (trim bezels) which cover the pivot shafts in the cowl. (Your originals will fit.) We stock the 47/53 escutcheons only.
- The intermittent switch must have the black wire grounded to function. This unit will not function if the motor assembly (truck body) is not grounded. You cannot use a battery charger to test the intermittent system.
- Please use proper eye protection when working beneath your dashboard, as you will be using power tools to cut and/or grind metal.

•First: DISCONNECT YOUR BATTERY•

**You will be working under the dash in the area of your vehicle
that contains the greatest concentration of electrical wiring.**

• DISASSEMBLY OF YOUR EXISTING WINDSHILED WIPER SYSTEM •

- The more room you can make for yourself in the middle of the dash the better.
- Begin by removing the defroster ducts and radio from beneath the center of the dash. You do not need to disturb the cowl vent. The cowl vent will work with our system.
- Remove the original arms and blades.
- Remove the original outside escutcheons and escutcheon nuts.
- Remove original links and pivot shafts.
- Remove original vacuum motor.
- Remove the original control knob and switch, and save the control knob for use with the RAINGEAR system.
- **Remove and plug the vacuum line to your intake manifold.**
- Remove and set aside your interior windshield trim.

1947 – 1953: You do not need to remove the original vacuum motor brackets.

1954: Remove the original vacuum motor brackets as shown in Figure 1.

• INSTALLATION •

1947-1953: Determine the center of your dashboard, Drill two ¼" diameter holes. See Figure 2.
(The holes you drill will be beneath your windshield trim. Remove your windshield trim).
1954 trucks have hole locations already dimpled in the correct locations.

•Pre-assemble the links (See Figures 3, 4, and 5) •

- Begin by adding the "S" shaped reinforcement to each link using four 10-32 x ½" screws, and hex nuts.
- Add the link extensions as shown in Figures 3 and 4.
- Apply the plastic bushing and ring to the outboard hole of the links in the order shown in Figure 5. The bushings are designed to be a very tight fit.
- Add bushings to the inboard end of the links as shown in Figure 4.
- Fasten the links to the pivot shafts (grease the brass pins) adding the special thin washer and a J-clip. You can use the side of a ¼" open-end wrench to push and slide the spring clip onto the brass pivot pin. See Figure 5.
- Add the body adapter to the pivot shaft and link assemblies and install in the vehicle. The right-hand assembly is the longer one. See Figures 3 and 4.
- Add the outside gasket, the chrome escutcheon, and the escutcheon nut. Tighten with the included escutcheon nut wrench. See Figure 5.

• INSTALLATION OF MOTOR ASSEMBLY •

- Attach motor support (A) to drive unit (B). See Figure 4
- Place ¼" x ½" hex bolts down through the holes that you drilled. (beneath the windshield trim)
- Raise the drive assembly up and onto the exposed bolts as shown in Figure 4. Make sure that the right-hand link is not trapped forward of the drive assembly. Secure with hex nuts. Four hands are useful for this step.
- Apply heavy axle grease to brass pins. Secure links to motor pivot pins as shown in Figure 3 and 4. This can be difficult because of the tight work area.
- Install the motor brace. The ¼" hole goes to the forward 5/16" hole in the stock bracket which holds the cowl vent handle.
- Place the control switch into the original switch location and secure.
- Secure the wire harness to the connector on the Motor. See wiring diagram.
- The red wire (power wire) should be connected to a fused 5 amp source that is not shared with other accessories.

Intermittent switches MUST be grounded in order to work. A battery charger does not provide the proper wave form to operate the switch. Please use a fully charged 12-volt battery.

PLEASE TEST YOUR SYSTEM BEFORE ADDING WIPER ARMS AND BLADES.

- Reinstall the defroster ducts.

**NOTE: The right hand link may strike the defroster ducts on some trucks.
You *may* need to bend the duct inboard for clearance.**

Figure 1
1953 & 1954 Chevy Truck

Underside of Dash

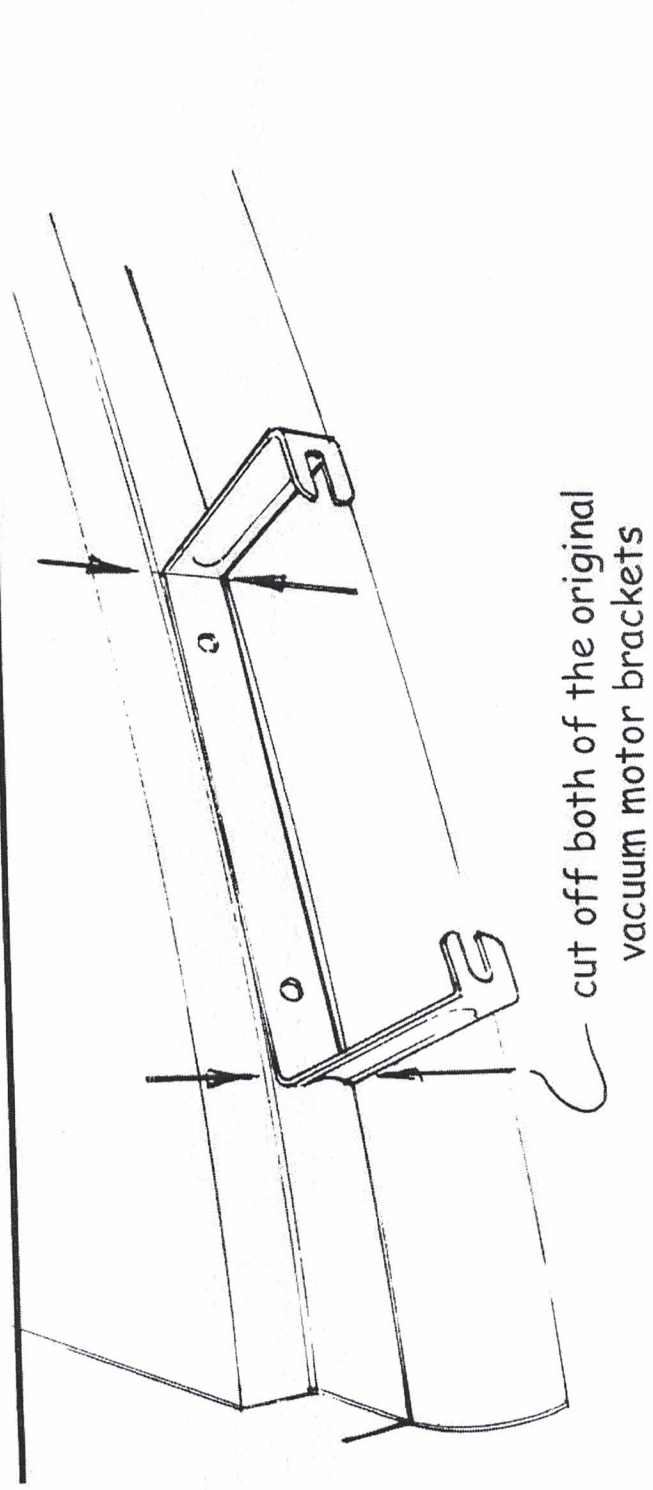

Figure 2
1947 - 1954
Chevrolet/GMC Truck

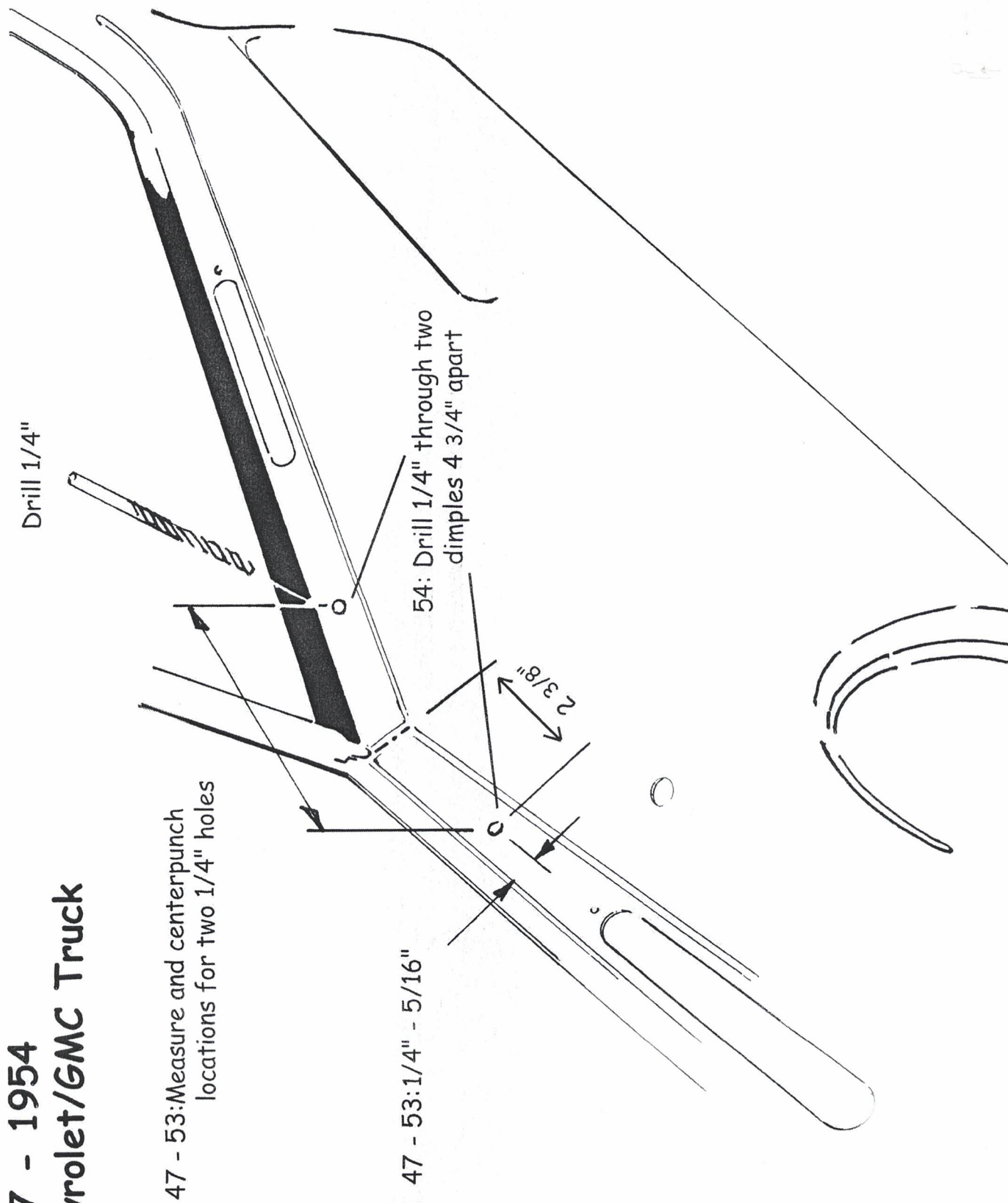
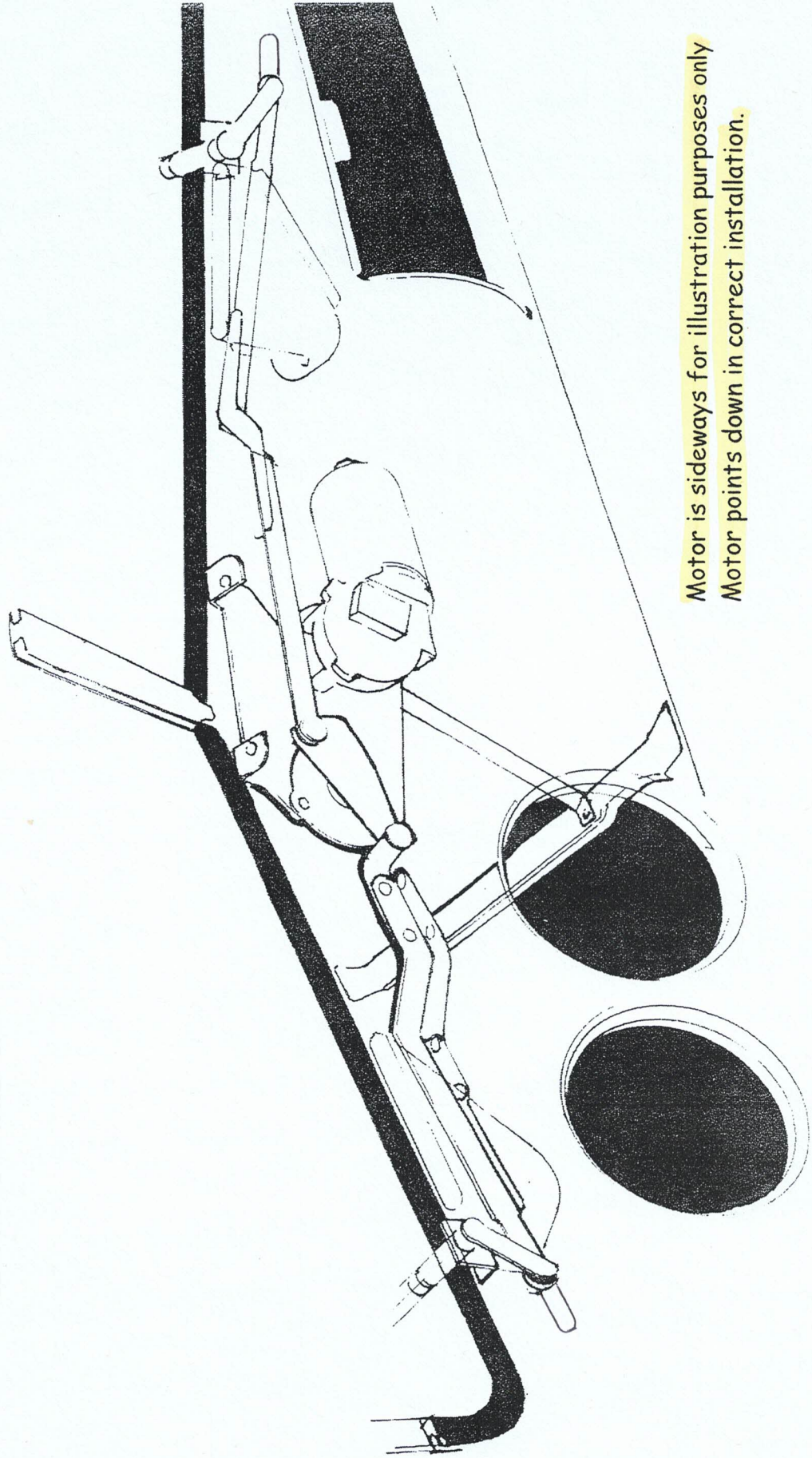

Figure 3
1947 - 1954
Chevrolet/GMC Truck



Motor is sideways for illustration purposes only
Motor points down in correct installation.

Figure 4
1947 - 1954
Chevrolet/GMC Truck

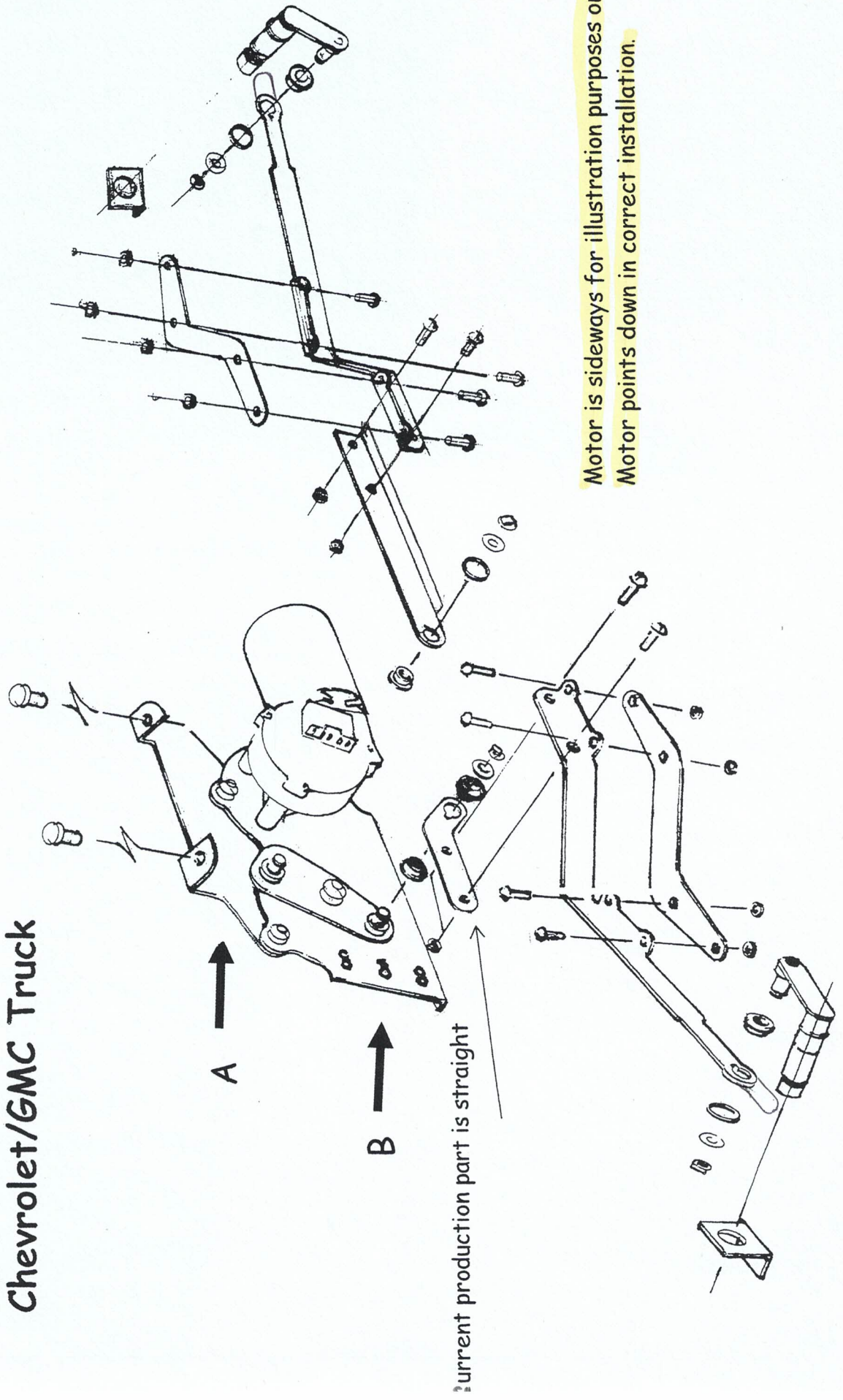

Figure 5
1947 - 1954
Chevrolet/GMC Truck

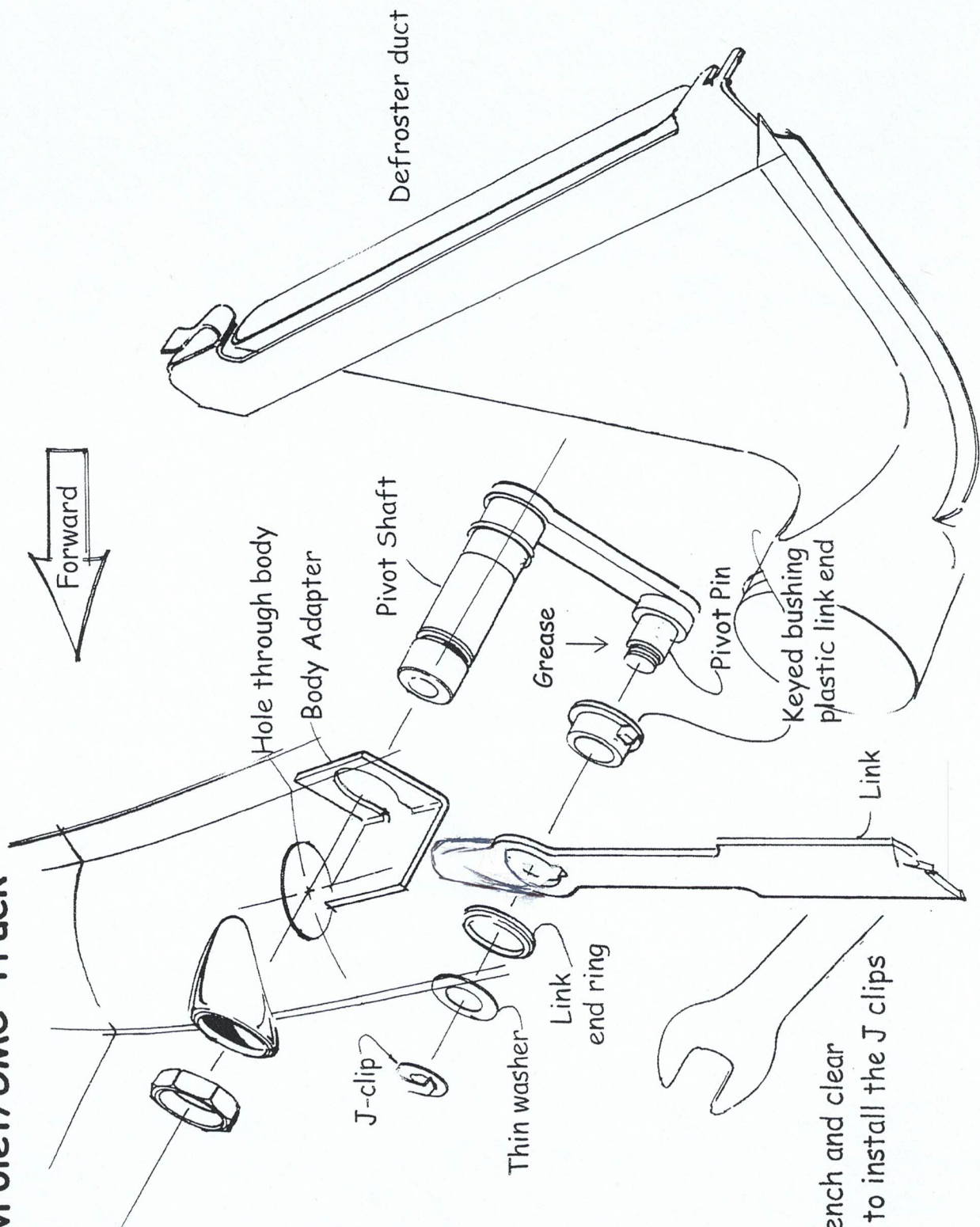
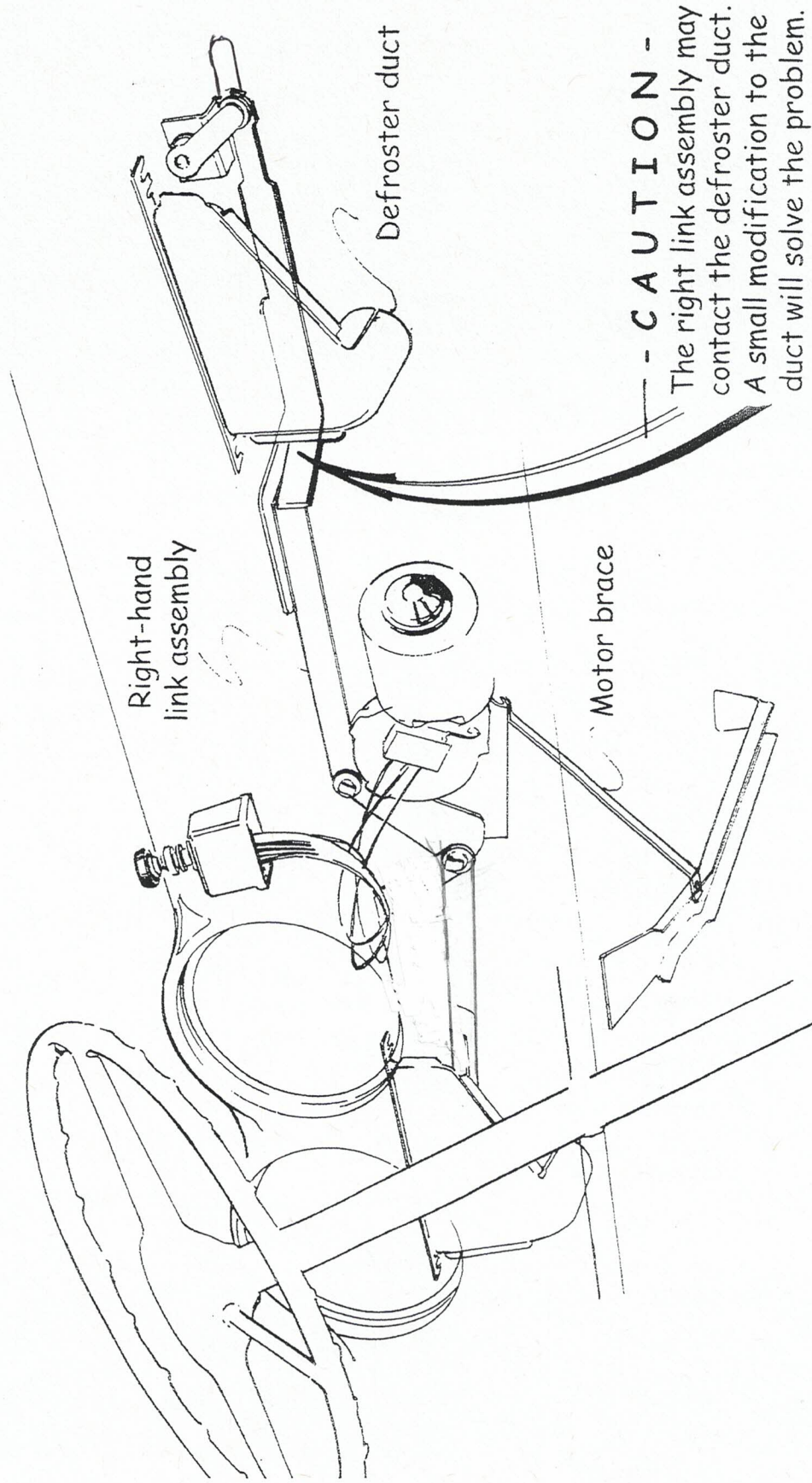

Figure 6
1947 - 1954
Chevrolet/GMC Truck



Motor is sideways for illustration purposes only
Motor points down in correct installation.

RAINGEAR

Wiring Diagram

2 Speed Switch

Turn knob to activate wipers.

The detents are definite - you will hear and feel a click between off, low, and high.

If running a washer system, push knob to squirt washers.

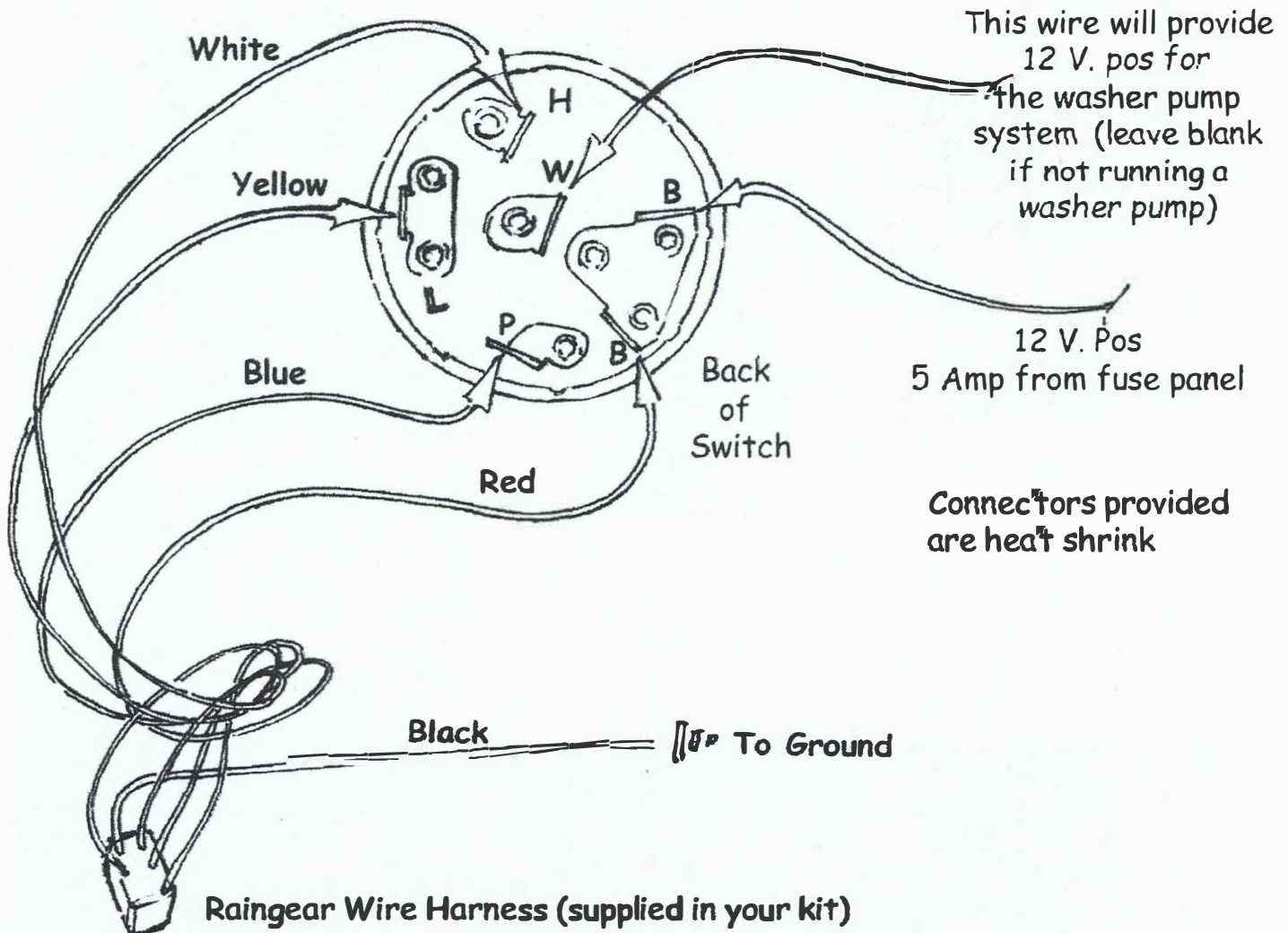
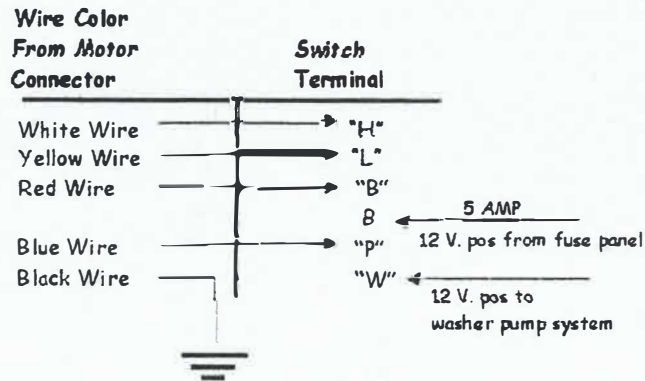

RAINGEAR

Wiring Diagram

2 Speed/Intermittent Switch

Please Note:
The Intermittent Switch
CANNOT be tested
on a Battery Charger

Turn knob to
operate wipers and
adjust speed.
The detents are
definite - you will
hear and feel a click
between off, low, -
and high.

If running a washer
system, push knob
to squirt washers.
The wiper blades
will cycle twice

12 Volts, pos
5 amp fuse
from fuse panel

Connectors provided are
heat shrink

Black wire from Raingear
wire harness must
be grounded

NOTE: The colors of the wires from the wiper
motor and the colors of the wires on the harness
do not match. This is correct.

